

PLAT OF SURVEY

LOT 12, BLOCK 5, WILSON'S ADDITION TO THE VILLAGE ( NOW CITY) OF WHITEWATER, being a part of the Northwest 1/4 of Section 4, Town 4 North, Range 15 East, City of Whitewater, Walworth County, Wisconsin.

Surveyed for: Tincher Realty  
Survey address: 408 Jefferson Street

60' WIDE  
**WILSON ST.**  
UNIMPROVED  
60.00'

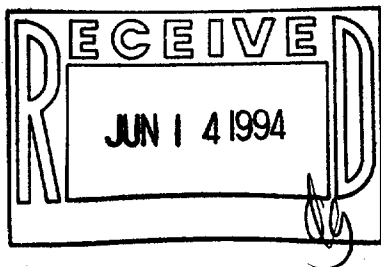

- FOUND 1" IRON PIPE
- FOUND 3/4" REBAR
- SET 1" IRON PIPE

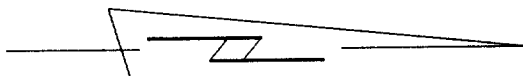

SCALE 1"=50'

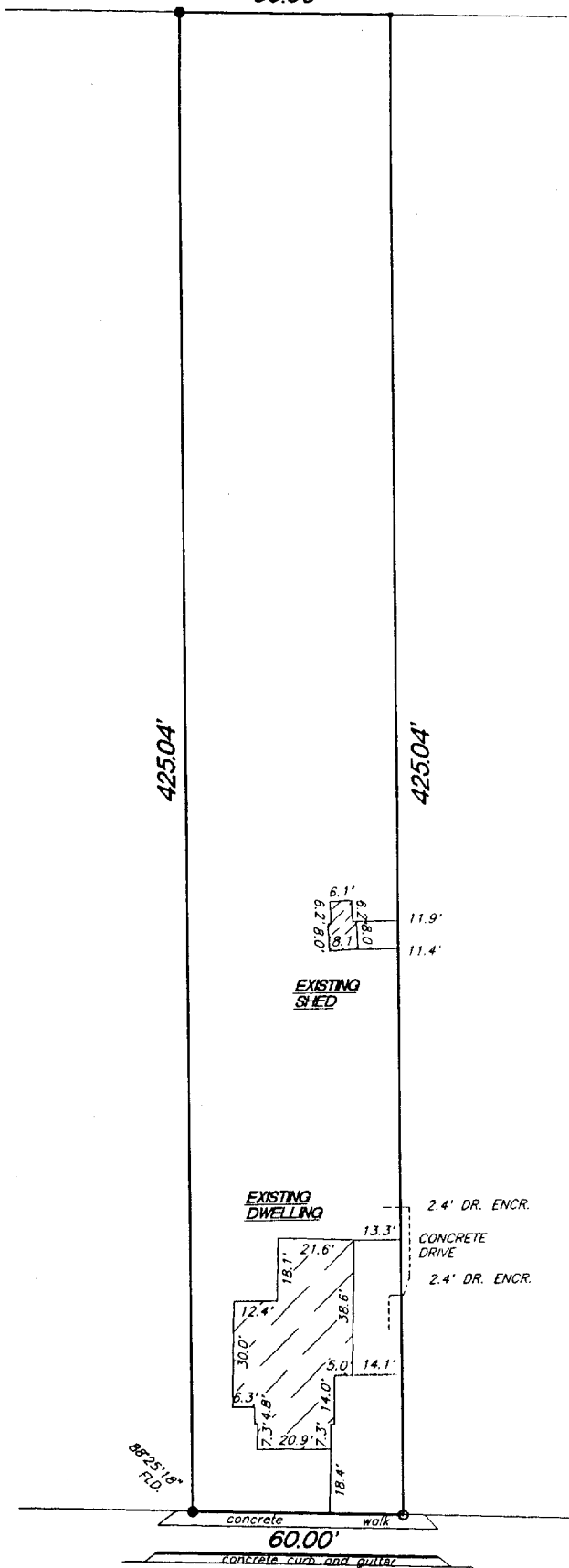

**JEFFERSON ST.**  
60' WIDE

"I hereby certify that I have surveyed the above described property and that the above map is a true representation thereof and shows the size and location of the property, its exterior boundaries, the location of all visible structures and dimension of all principal buildings thereon, boundary fences, apparent easements, roadways and encroachments if any."

"This survey is made for the use of the present owners of the property, and also those who purchase, mortgage or guarantee the title thereto within one year from date hereof."

KETTLE MORaine SURVEYING  
W362 S10227 Lewin Lane  
Eagle Wisconsin 53119  
(414) 594-3484

Terrance E. Pisarek R.L.S.

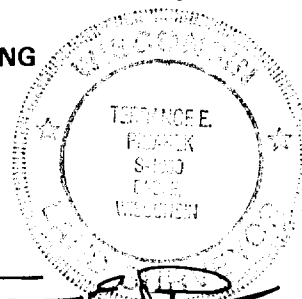

THIS IS NOT AN ORIGINAL SURVEY UNLESS THE SEAL IS RED.

4/25/94

DATE

TEP/DAF

FIELD WORK BY

TEP

DRAWN BY

84048

JOB NUMBER

/WSS-54

10-524